

IT IS A VIOLATION OF THE LAW FOR ANY PERSON, UNLESS ACTING UNDER THE DIRECTION OF A LICENSED ARCHITECT TO ALTER THESE PLANS AND SPECIFICATIONS. THIS DOCUMENT CONTAINS PROPERTY INFORMATION AND SHALL NOT BE USED OR REPRODUCED, OR ITS CONTENTS DISCLOSED, IN WHOLE OR IN PART, WITHOUT THE PRIOR WRITTEN CONSENT OF GALLO HERBERT ARCHITECTS. COPYRIGHT 2021 GALLO HERBERT ARCHITECTS

LEGAL DESCRIPTION - PARCEL Y
A PARCEL OF LAND BEING A PORTION OF PARCEL A, POMPANO BEACH AIR PARK F.B.O. PHASE 1, ACCORDING TO THE PLAT THEREOF AS RECORDED IN PLAT BOOK 171, PAGES 189-194, OF THE PUBLIC RECORDS OF BROWARD COUNTY, FLORIDA, SAID PARCEL BEING MORE PARTICULARLY DESCRIBED AS FOLLOWS:

COMMENCE at the Northeast corner of said parcel A;
THENCE on an assumed bearing of S 88 Degrees 50' 42" W along the North line of said Parcel A, a distance of 36.45 feet to the POINT OF BEGINNING
THENCE continue S 88 Degrees 50' 42" W continuing along the said North line of Parcel A, a distance of 793.70 feet;
THENCE S 13 Degrees 04' 56" W a distance of 330.17 feet to the North line of Parcel A, GOODYEAR BASE, according to the plat thereof as recorded in Plat Book 114, page 24, of the Public Records of Broward County, Florida;
THENCE S 82 Degrees 41' 26" E along the said North line of Parcel A, GOODYEAR BASE and the Easterly prolongation thereof a distance of 818.56 feet to a line being 131.00 feet West of and Parallel with the centerline of Taxiway Bravo;
THENCE N 07 Degrees 16' 14" E along said parallel line a distance of 445.32 feet to the POINT OF BEGINNING.
Said Lands situate within the City of Pompano Beach, Florida containing 7.10 acres, more or less.

see sketch and Legal Description of Pompano Beach Air park Parcel Y by: AWN Design & Consulting Group, Inc Surveyors Mappers Designers Deerfield beach Florida. dated 3/7/15

ZONING: T TRANSPORTATION NOT DIRECTLY ADJACENT TO ANY OTHER ZONING.	SITE CALCULATIONS: 309,262.67 SF (7.10 ACRES)	COVERAGE	PARKING:
LEASE AREA: 309,264.61 SQUARE FEET : 7.0997 ACRES	TOTAL BUILDING AREA A= 22,400 SF B= 11,880 SF C= 13,513 SF D= 9,620 SF E= 9,620 SF F= 9,620 SF	76,653 SF 24.8 %	1ST 10,000 SF / 500 = 20 SPACES BALANCE 66,653 SF / 1000 = 67 SPACES TOTAL = 87 SPACES REQUIRED TOTAL SPACES PROVIDED = 89 ACCESSIBLE SPACES REQUIRED = 4 ACCESSIBLE SPACES PROVIDED = 6 BICYCLE PARKING- 4 SPACES PER 10 CAR SPACES REQUIRED NOT TO EXCEED 20 BIKES. PROVIDE 20 BIKE SPACES
SEE SURVEY SHEETS 1 AND 2 BY CAULFIELD & WHEELER, INC JEFFREY WAGNER, PLS	FUEL STORAGE AREA AIRCRAFT PARKING PADS CONC. SIDEWALK AREA DUMPSTER ENCLOSURE AREA TOTAL PAVED AREA (CONC.)	480 SF 184,521 SF	
	TOTAL IMPERVIOUS AREA: TOTAL PERVIOUS AREA:	184,521 SF 48,089 SF	59.7 % 15.5 %

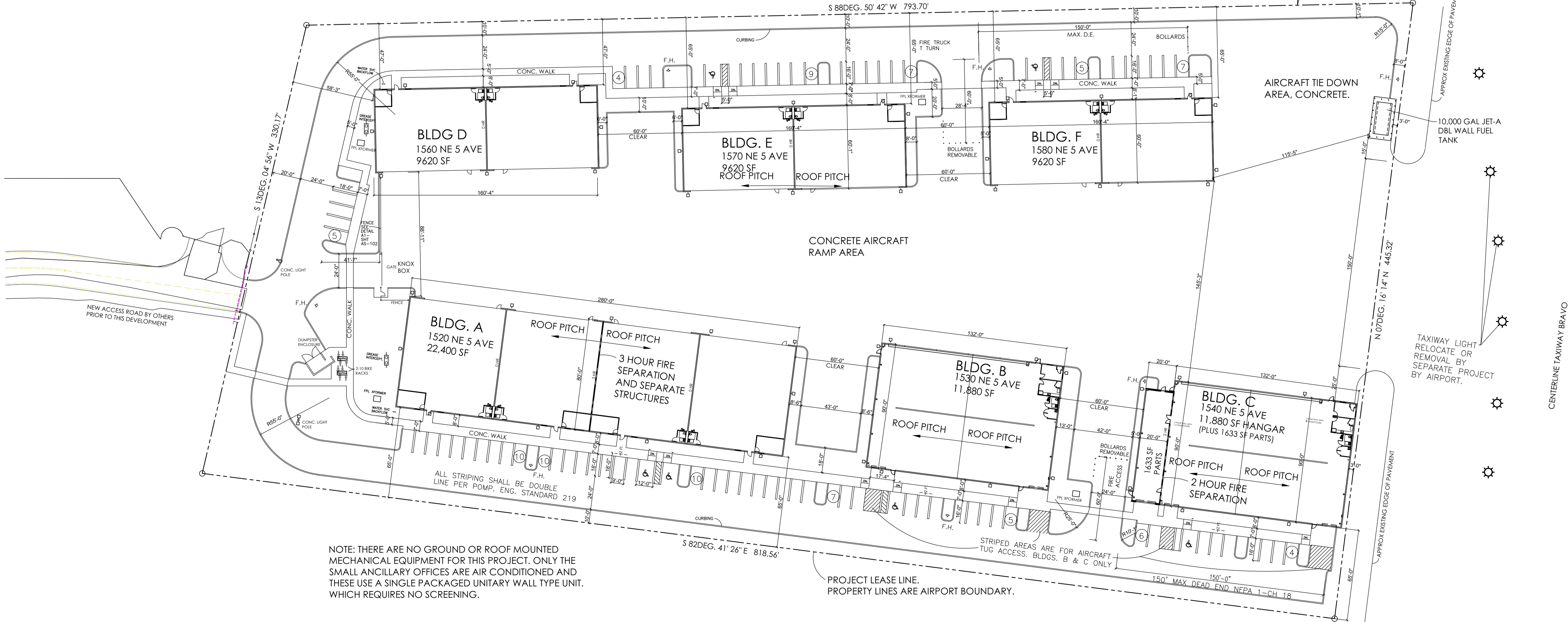

NOTE: THERE ARE NO GROUND OR ROOF MOUNTED MECHANICAL EQUIPMENT FOR THIS PROJECT. ONLY THE SMALL ANCILLARY OFFICES ARE AIR CONDITIONED AND THESE USE A SINGLE PACKAGED UNITARY WALL TYPE UNIT, WHICH REQUIRES NO SCREENING.

PROJECT LEASE LINE.
PROPERTY LINES ARE AIRPORT BOUNDARY.



DRC
PZ22-12000020
9/21/2022

GHA
GALLO HERBERT ARCHITECTS
1311 W NEWPORT CENTER DRIVE DEERFIELD BEACH, FLORIDA 33442 PH. 954.794.0300 F.X. 954.0300
AA226001731
SEAL
WILLIAM J. GALLO FL AR0008440

Brian Herbert
Digitally signed by Brian Herbert
Date: 2022.08.09 16:28:16 -04'00'
BRIAN P. HERBERT FL AR0015474

POMPANO BEACH AIR PARK PARCEL Y

601 NE 10TH ST.
POMPANO BEACH
FL 33060

POMPANO BEACH

COMPANY NAME		
REVISIONS		
No.	Description	Date
B	D.R.C. SUBMITTAL	2022-06-28
	D.R.C. RESPONSE	2022-08-05

PROJECT STATUS	
D.R.C.	DATE
2021-03-24	
PROJECT NUMBER	83-2020
SCALE	AS SHOWN
DRAWN BY	CHECKED BY
JET	JET
DRAWING TITLE	

SITE PLAN

DRAWING NUMBER

AS-101